

QUICK START GUIDE

LET'S SETUP YOUR FABRIQ® CHORUS

This guide gives you a quick overview on setting up your new FABRIQ® CHORUS. For complete product information, download the instruction booklet and view our how-to videos on thefabriq.com.

For any questions or help, get in touch with us:

EMAIL: support@thefabriq.com

PHONE: 1 · 844 · 932 · 2747

DOWNLOAD THE APP & POWER ON

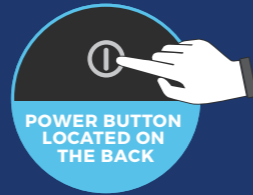

Download the FABRIQ® App by visiting thefabriq.com or download directly from the App Store or Google Play. FABRIQ® CHORUS comes pre-charged and ready to use. Press and hold the power button for 3 seconds until you see the light begin to flash.

FABRIQ® APP + SETUP



WiFi: Setup the speaker with WiFi using the FABRIQ® App. Use the app to pair up to 10 FABRIQ® speakers or control them individually.

BLUETOOTH: Press the 'Pair Button' to turn on the speaker's bluetooth & look for 'FABRIQ®' on your mobile device to connect.

AMAZON ALEXA APP & VOICE CONTROL

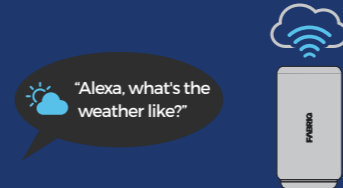

Download the Amazon Alexa App from the App Store or Google Play. Create an Amazon account or sign into your existing one to control your FABRIQ® speaker using Amazon Alexa Voice Service - just say Alexa to interact with the speaker.

HOW TO RESET

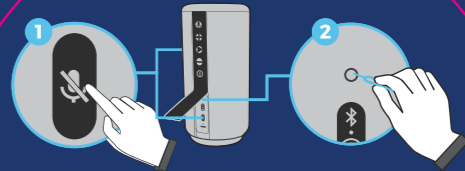

1 To reset & clear all previous WiFi settings and data, press and hold the Mute button for approximately 10 seconds until you hear the audio prompt stating that all data has been reset.

2 In the rare case that your FABRIQ® CHORUS is frozen and no buttons are functional, please use this pin to restart the speaker by inserting into the hole above the Pair Button.

BOTTOM



FRONT VIEW



Multi-Color Light Ring

- Bluetooth ● WiFi/Amazon Alexa ●
- Low Battery/Mic Mute ●

BACK CONTROLS

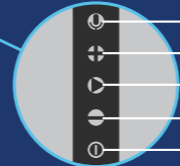
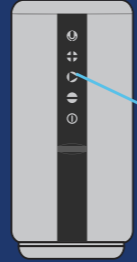

- Tap and Talk
- Volume Up
- Play/Pause
- Volume Down
- Power Button

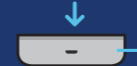

Includes Charging Cradle

UNDER THE FLAP

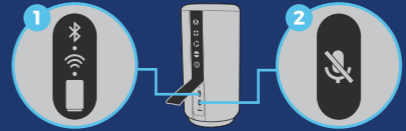

1 PAIR BUTTON

Switch between Bluetooth & WiFi mode

2 MUTE BUTTON

Press the Mute button to disable the mic. When the light illuminates red the mic is turned off. Press again to reactivate the mic.

QUESTIONS & SUPPORT

WEBSITE
www.thefabriq.com

HOW-TO VIDEOS
www.thefabriq.com/contact-us

DOWNLOAD THE INSTRUCTION BOOKLET
www.thefabriq.com/user-manual

EMAIL
support@thefabriq.com

CUSTOMER SERVICE
1 · 844 · 932 · 2747